

**Controlled document**  
Pivexin Technology Sp. z o.o.

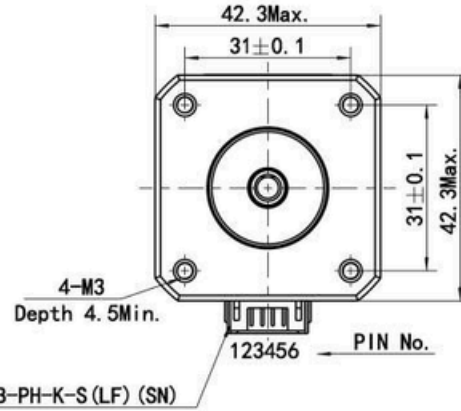

Wiring Diagram

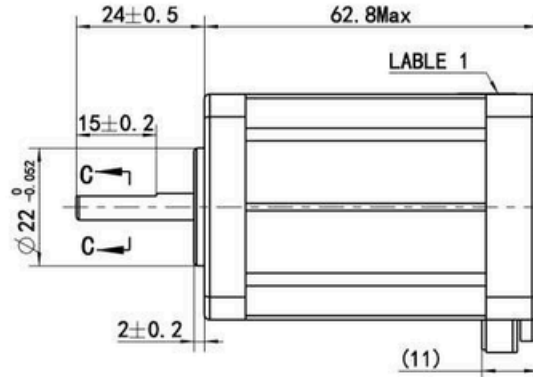
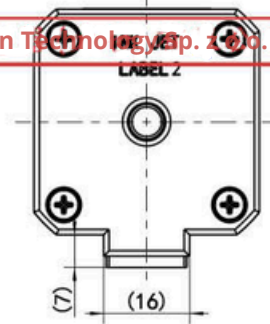
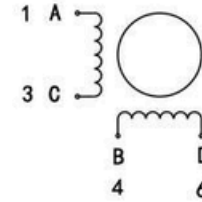

Exciting Sequence vs. Direction of Rotation

STEP	A	B	C	D	CCW
1	+	+	-	-	↑
2	-	+	+	-	
3	-	-	+	+	
4	+	-	-	+	

CW ↓

Clockwise view from mounting side

Label 1 Detail

**STEPPING MOTOR**

Insulation: Class B, 60VDC Max.

2Amps Holding: 0.83Nm

3000RPM Max.

**PIVEXIN**

UL FILE No. E465363 XXX Factory ID

Label 2 Detail

TYPE MS17HDBP4200

XXXXXXXX YY/MM/DD

Work Order      Date Format

1. Number of Phase	2
2. Step Angle	1.8°
3. Rated Voltage	2.98 V DC
4. Rated Current	2 Amp
5. Holding Torque	0.83 Nm Typ. (Two phase on/rated current)
6. Phase Resistance	1.49 ohm±10% (20°C)
7. Phase Inductance	3.8 mH±20%(1kHz 1V rms)
8. Rotor Inertia	123 gcm <sup>2</sup>
9. Motor Weight	0.6 kg
10. Insulation Class	B (130°C)

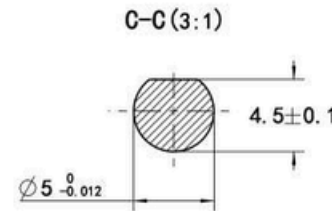

REV.	REVISION RECORD	DATE	UNLESS OTHERWISE SPECIFIED
D1		2023. 05. 15	
D0	Update nameplate	2017. 04. 24	
C	Change the nameplate, 800mN.m	2013. 01. 24	
B	Adjust specifications and label	2012. 03. 15	
A	Original revision	2011. 07. 18	

APPROVE	NAMES	SIGNATURE	DATE
Approve			
Standardize			
Process Review			
Check			
Design			

# PIVEXIN

## TECHNOLOGY

Drawing No: 4611110008908    Rev. D1    SCALE: 1:1    Sheet 1 of 1